



HIAWATHA SPORTSMAN'S CLUB

Campground Accommodations

PHONE: 906-477-6592 Email: Reservations@hiawathaclub.com

Campground

The Hiawatha Sportsman's Campground is located on Greylock Road south of Hiawatha Trail (H-40) along the banks of the beautiful Millecoquins River. *(See page 3 for location)*

Campsites are equipped with electrical hookups. Each campsite has a 15-amp and a 30-amp circuit. One campsite (Lot #9) has a 50-amp circuit.

Water and dump station facilities are available at the campground.

Campfire pits and picnic tables are available on each site. Firewood is available on site.

The campground is open year-round to members; however, the road is not maintained in the winter. Water in the campground is turned off once the weather stays below freezing.

** Guests are welcome to stay year-round.* Guests need to pick up a special key at the office to access the campground, which requires a sign out process. *Campground guests are prohibited from using Club Trails unless a sponsoring member accompanies them.* This Rule does not apply to the direct access trails to the Club Beach, Golf Course, Campground, and Trap Range.

Campground users are asked to respect the rights of other campground users and refrain from loud and noisy activities. Sponsoring members must not leave campground users under age 18 unattended. Fires are only permitted in approved campsite pits. Camping trailers or other camping structure must not be stored or left unattended at the campground.

Campground Reservations

Campground sites *must be reserved*, and reservations are made through the Club Office.

The campground map at the end of this document (*page 4*) can help when selecting a camping site to reserve that will meet your needs. Once you arrive, your reservation tag will be available for you at the Club Office. If you will be arriving after office hours, please call ahead for our after-hours registration procedure. The registration tag will include the name of the camper, the type of camping, and the days of occupancy. This tag must be displayed at the campsite. Daily fees for members and guests are listed on page 2. A daily fee will be assessed each day the campsite is occupied by a trailer, camper, or tent. Fees vary accordingly for tent camping or non-tent/RV camping.

Campground Cabins

Two Campground Cabins are available for reservation through the Club Office. They are located on the banks of the Millecoquins River. The cabins sleep four people, each having 2 bunk beds and electricity. Bedding is not provided.



HIAWATHA SPORTSMAN'S CLUB

Campground Accommodations

PHONE: 906-477-6592 Email: Reservations@hiawathaclub.com

Campground Reservations are taken at the Club Office

Reserving a campsite must be done at the Club Office. Registration tags must be displayed. Please see the campground map to select a site that will meet your needs.

TENT Camping

MEMBER RATE: \$11.00/night

GUEST RATE: \$16.00/night

NON-TENT / RV Camping

MEMBER RATE: \$ 21.00/night

GUEST RATE: \$ 31.00/night

Rustic Cabin

MEMBER RATE: \$26.00/night

GUEST RATE: \$42.00/night

RATES – Tent, Non-Tent/RV, and Rustic Cabin Rates vary.

These rates are effective starting March 1, 2025. Rates are subject to change without notice.

For more information call the HSC Office (906) 477-6592

email: info@hiawathaclub.com

The Club Office is located at N7269 Lake Blvd., Engadine, MI 49827

Office Hours: Monday – Friday, 8:00 AM – 4:30 PM

PEAK SEASON Office Hours: EVERYDAY, 8:00 AM – 4:30 PM

Peak Season is the last full week of June – the second week of August



HIAWATHA SPORTSMAN'S CLUB

Campground Accommodations

PHONE: 906-477-6592 Email: Reservations@hiawathaclub.com

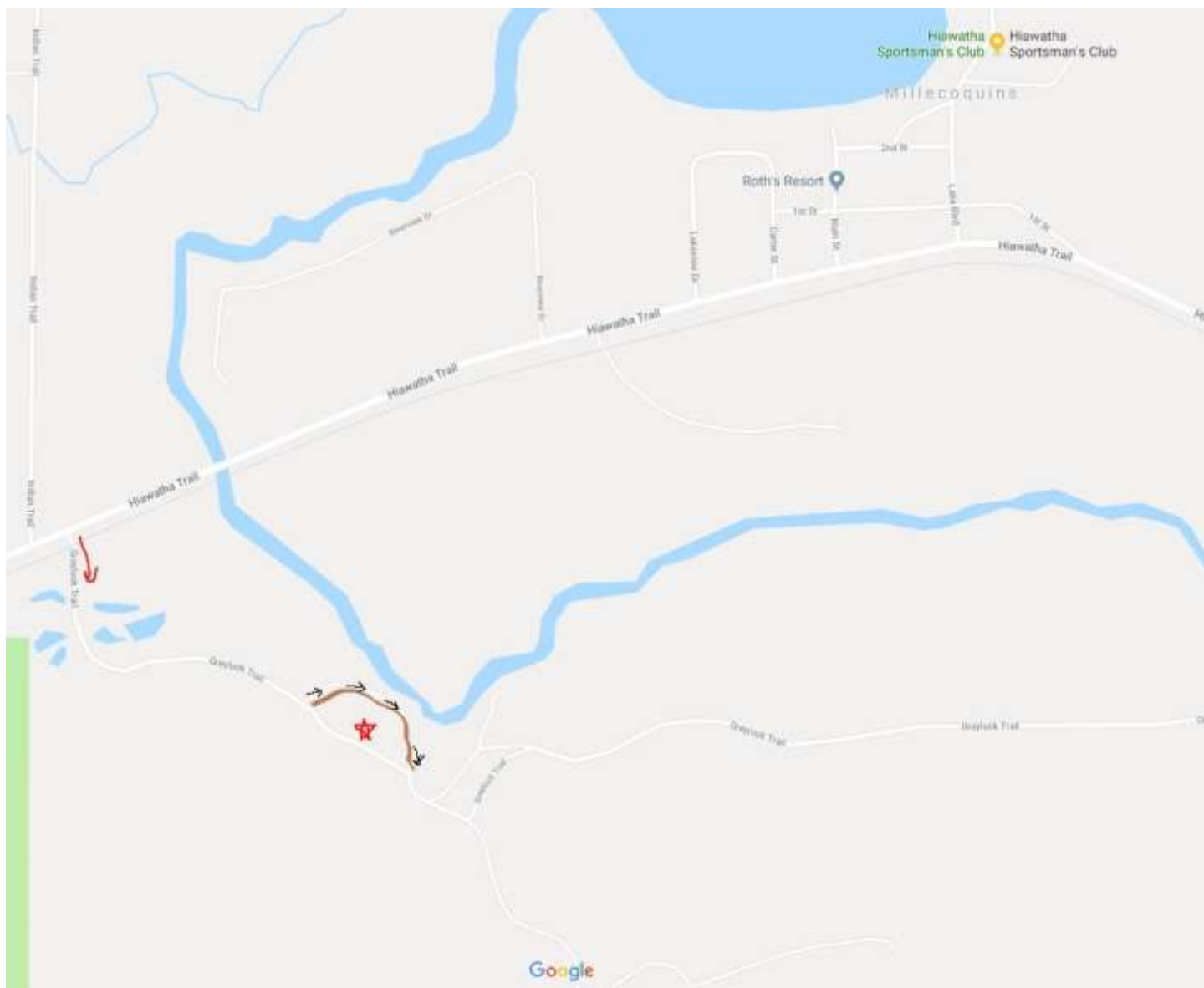

The HSC campground is located off Greylock Trail, south of H-40 (Hiawatha Trail) in Engadine, Michigan.



Campground Map

Horse Tie-Ups

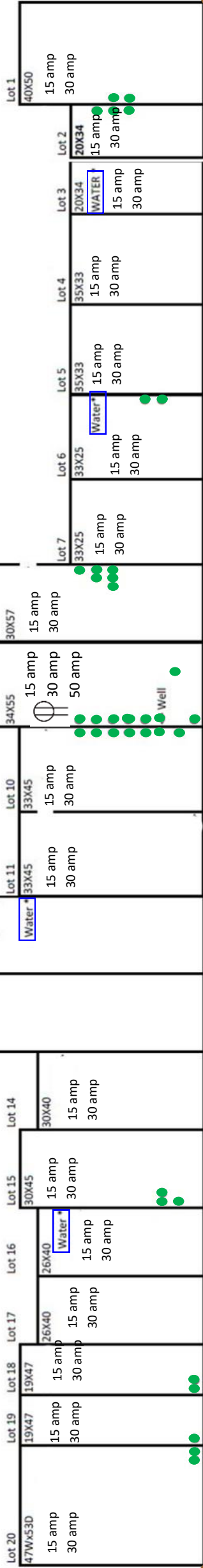
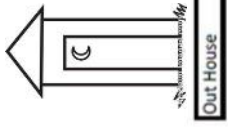
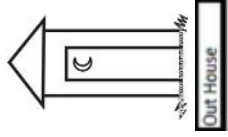

Campground road —off of Greylock Trail

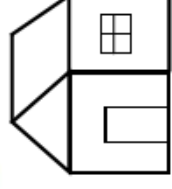

Rustic Cabin #1

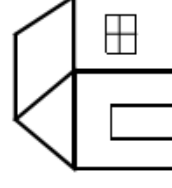

Rustic Cabin #2

Reservations for a campground site is required.

Call the Club Office to reserve a site for your stay.

Sizes of campsites are noted. Each site has a 15 amp & 30 amp outlet available. Lot #9 has 15, 30 & 50 amp available.

Campfire rings and picnic tables are provided.

All water is shared, and not ONLY for the lot where located.

Trees and bushes are noted for your convenience. ●●●

Dump station is located on the campground road, leading out back to Greylock Trail.



Shower facilities are located inside the HSC Recreation Building.

